

DESIGN CONDITIONS

Max. working pressure*	16 Bar.g
Burst Pressure*	>50 Bar.g
Vacuum Rating*	500mm HG
Temperature Range	-10 to 90°C
Test Pressure*	24 Bar.g.
Design Life	10 Years

*at ambient temperature

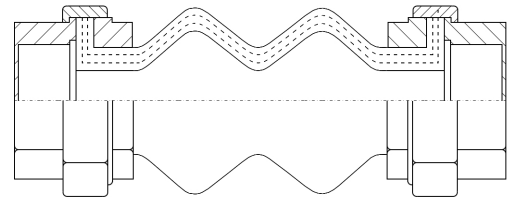

CONSTRUCTION MATERIALS

Bellows (outer)	EPDM, hot water resistant
Bellows (inner)	EPDM, ozone proof, warmth resistant
Reinforcement	High tensile synthetic fabric
Unions	304 stainless steel

UNIT IDENTIFICATION:

Manufacturer, Size, Elastomer, Date Stamp, Type No.

SPECIFICATION

Thermosel type TRB/16/220 twin sphere EPDM rubber bellows. EPDM rubber membrane with high tensile synthetic reinforcement and steel wire reinforced faces. Unit supplied with galvanised female unions threaded to BS21.

TECHNICAL DATA

NOMINAL SIZE	PART NUMBER	NEUTRAL LENGTH	AXIAL COMPRESSION	AXIAL ELONGATION	LATERAL DEFLECTION	ANGULAR DEFLECTION
mm	TRB/____/16/220	mm	mm	mm	+/- mm	+/- Deg
15	TRB/0015/16/220	165	22	6	22	30
20	TRB/0020/16/220	165	22	6	22	30
25	TRB/0025/16/220	175	22	6	22	30
32	TRB/0032/16/220	186	22	6	22	30
40	TRB/0040/16/220	186	22	6	22	30
50	TRB/0050/16/220	200	22	6	22	20
65	TRB/0065/16/220	218	22	6	22	15
80	TRB/0080/16/220	260	22	6	22	15

TYPICAL APPLICATIONS

Thermosel rubber bellows are used to absorb vibration and attenuate noise caused by reciprocation plant such as pumps, chillers and air handling units. They are also used to compensate for small amounts of axial, lateral and angular pipework movements. Suitable for use on non ferrous pipework.

GENERAL INFORMATION

This range of expansion joints is comprised of an EPDM twin sphere moulded bellows having 304 stainless steel female unions for non ferrous applications. This feature facilitates installation. **Not suitable** for cooling water with oil containing additives, oily compressed air or permanent effect of steam.

Recommendations contained in our literature on correct installation of rubber expansion joints should be followed. These rubber bellows will extend in length when under pressure unless adequately anchored. When operating at elevated temperatures the maximum operating pressure should be derated; refer to pressure / temperature chart. Vacuum rating is based on the unit being installed at its neutral length; the unit should not be extended on installation.

ALTERNATIVES

Where a TRB/16/220 is not suitable, please contact *Thermosel Solutions* to discuss the alternative options.